

# SURVEY

McKellar Estate

Ac.  
63

TO STA. 1139+64.2  
TO STA. 1124+15

JOHNNY SMITH  
VOL. 405 PAGE 529  
DEED  
STA. 1133+64.2 TO STA. 1134+64.2  
0.2296

THURMAN FOSTER  
VOL. 405 PAGE 536  
DEED  
STA. 1127+14.2 TO STA. 1128+14.2  
0.2296 ACRES

1128+14.2

1123+93 R. 6.2  
1124+15  
County Road

1137+14.2  
150  
220

Proposed R.O.W. Line 7 1017'

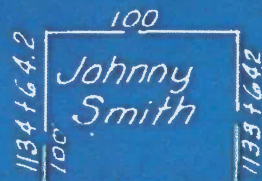

Relocated & Existing N. R.O.W. Line U.S. 80 7

1130

